

# "Stormwater Management Roof" Extensive with Retention Spacer RS 60

## Detail:

Wall Connection with Gravel Strip

## System build-up

- 1.1 Plant community
- 1.2 System Substrate
- 1.3 Filter Sheet SF
- 1.4 Floradrain® FD 25-E
- 1.5 Filter Sheet PV
- 1.6 Retention Spacer RS 60
- 1.7 Filter Sheet PV
- 1.8 Roof construction with root resistant waterproofing

## Please note:

The build-up described above is suitable for the moderate continental climate of Central Europe. For information on possible adaptations for other climates please contact the ZinCo Technical Department.

## Note:

The detailed solution shown here refers mainly to the ZinCo System Build-up. The roof construction itself as well as any other constructions are shown schematically and must be planned according to the relevant standards and guidelines.

## Project:

-

## Version:

20.12.2018 PBi/ EVo

## Reviewed:

-

## Scale:

none

## Size:

A 4

Wa01\_Ref\_Ext\_FD25\_Fd0.dwg

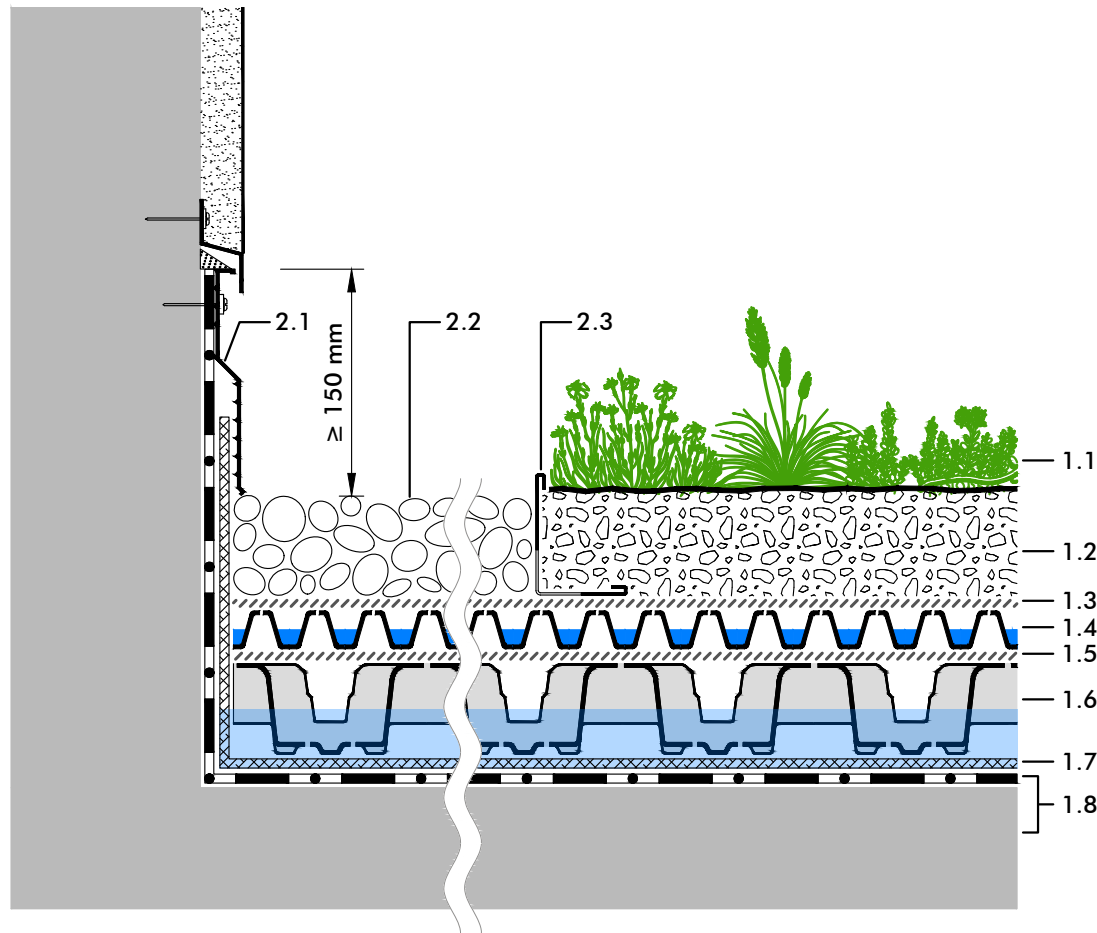

2.1 Clamping and Protection Profile AP 150

2.2 Gravel Strip

2.3 ZinCo Gravel Retainer KL

Authorized by ZinCo GmbH, Lise-Meitner-Str. 2,  
72622 Nuertingen/ Germany; Tel: + +49/7022-6003-0  
info@zinco-greenroof.com; www.zinco-greenroof.com



Subject to technical alterations and printing errors.