

# "Walk- and Driveway" with Stabilodrain® SD 30

**Detail:**  
Wall Connection

## System build-up

- 1.1 Paving, e.g. concrete pavers  
Depth:  $\geq 100$  mm for cars up to 3 t  
 $\geq 120$  mm for lorries up to 16 t  
 $\geq 140$  mm for lorries exceeding 16 t
- 1.2 Bedding layer, stone chippings, poor in lime, 30-50 mm
- 1.3 Compacted base layer, e.g. gravel, poor in lime  
Depth:  $\geq 150$  mm for cars up to 3 t  
 $\geq 200$  mm for lorries up to 16 t  
 $\geq 250$  mm for lorries exceeding 16 t
- 1.4 Filter Sheet PV
- 1.5 Stabilodrain® SD 30, filled with stone chippings (see 1.2)
- 1.6 Filter Sheet PV
- 1.7 Roof construction with suitable water proofing

## Note:

The detailed solution shown here refers mainly to the ZinCo System Build-up. The roof construction itself as well as any other constructions are shown schematically and must be planned according to the relevant standards and guidelines.

## Project:

-

Version:	Reviewed:	Scale:	Size:
28.11.2018 PBi/ EVo	-	none	A 4

Wa01\_G+F\_SD30\_Fd0.dwg

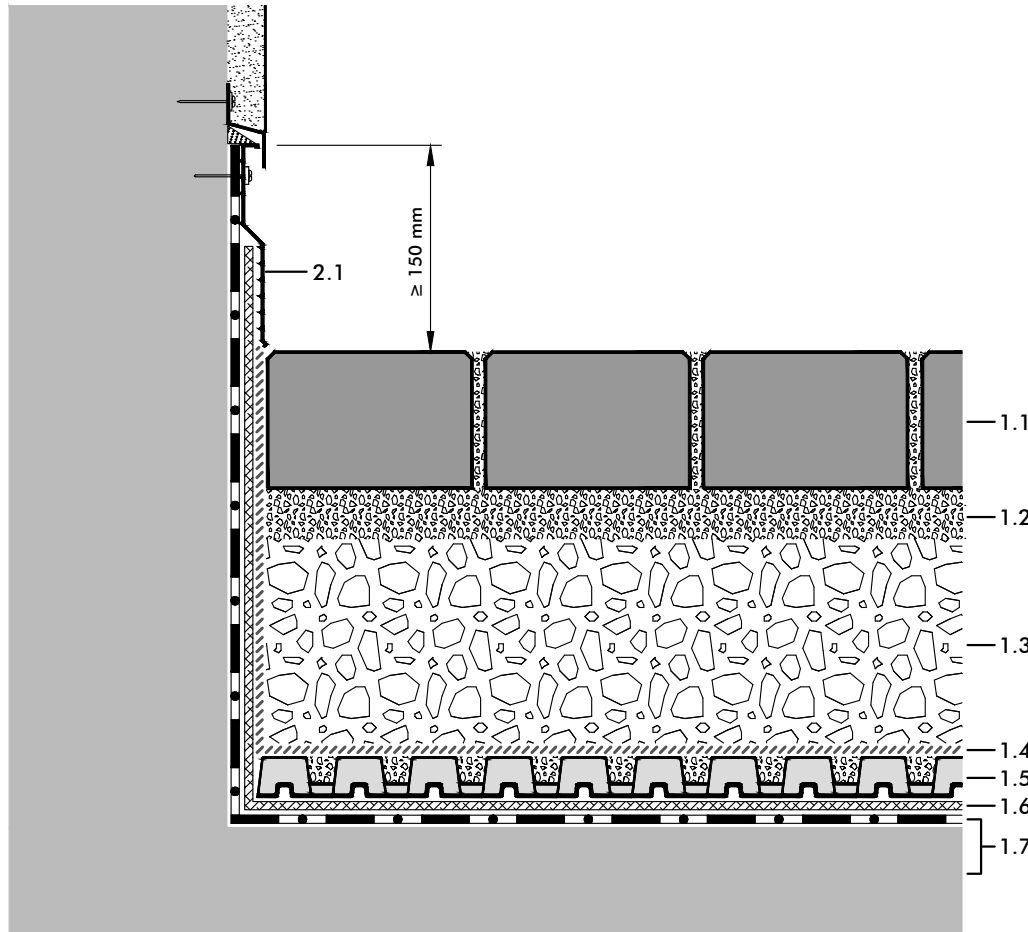

2.1 Clamping Profile AP 150

Authorized by ZinCo GmbH, Lise-Meitner-Str. 2,  
72622 Nuertingen/ Germany; Tel: +49/7022-6003-0  
info@zinco-greenroof.com; www.zinco-greenroof.com

Subject to technical alterations and printing errors.

