

"Driveway" with Protectodrain® PD 250

Detail:
Wall Connection

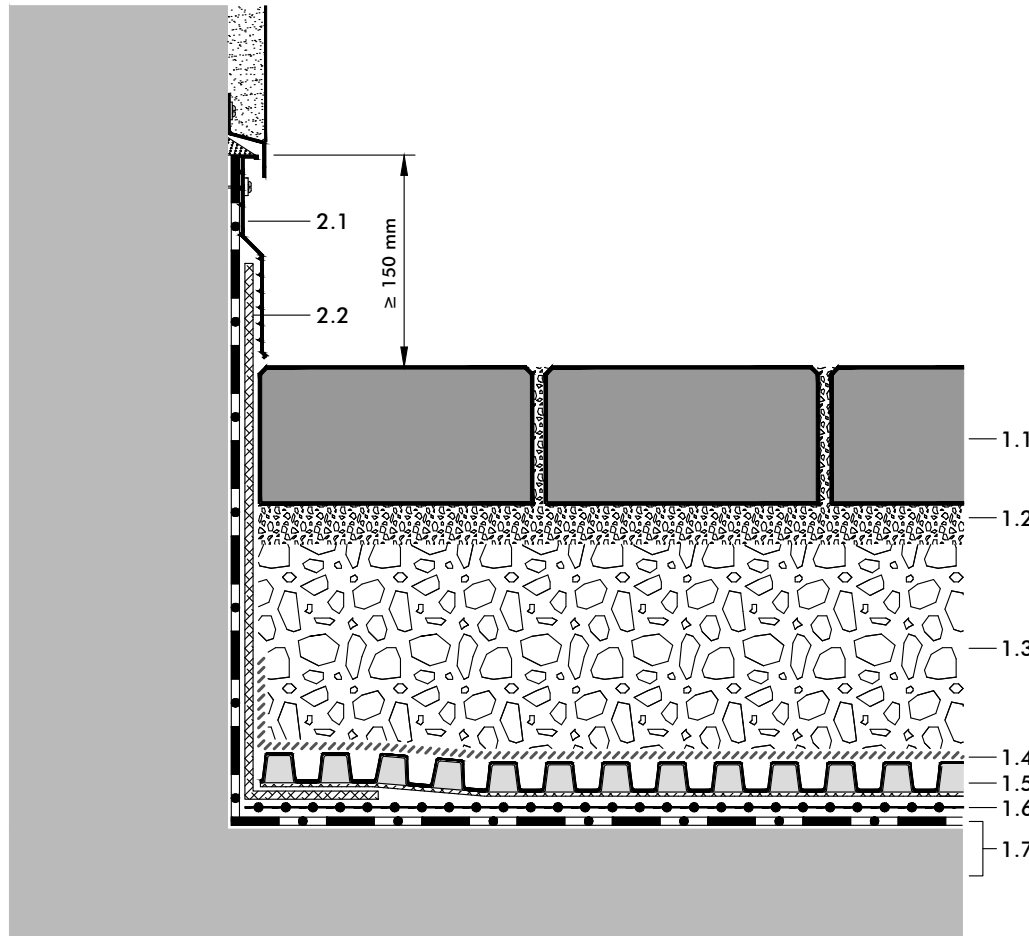

- 2.1 Clamping Profile AP 150
2.2 Protection Mat Strip RS-M

System build-up

- 1.1 Paving, e.g. concrete pavers
Depth: ≥ 100 mm for cars up to 3 t
≥ 120 mm for lorries up to 16 t
≥ 140 mm for lorries exceeding 16 t
- 1.2 Bedding layer, poor in lime, 30-50 mm
- 1.3 Gravel base layer, poor in lime
Depth: ≥ 150 mm for cars up to 3 t
≥ 200 mm for lorries up to 16 t
≥ 250 mm for lorries exceeding 16 t
- 1.4 Filter Sheet PV
- 1.5 Protectodrain® PD 250
- 1.6 Slip Sheet TGF 20 (2 layers)
- 1.7 Roof construction with root resistant waterproofing

Note:

The detailed solution shown here refers mainly to the ZinCo System Build-up. The roof construction itself as well as any other constructions are shown schematically and must be planned according to the relevant standards and guidelines.

Project:

-

Version: 26.11.2018 **Reviewed:** EVo/ JGI - **Scale:** none **Size:** A 4

Wa01_G+F_PD250_Fd.dwg

Authorized by ZinCo GmbH, Lise-Meitner-Str. 2,
72622 Nuertingen/ Germany; Tel: ++49/7022-6003-0
info@zinco-greenroof.com; www.zinco-greenroof.com

Subject to technical alterations and printing errors.

