

"Driveway" with Retention Spacer RSX 65

Detail:

Door Exit with Drainage Channel

System build-up

- 1.1 Paving, e.g. concrete pavers
Depth: ≥ 100 mm for cars up to 3 t
 ≥ 120 mm for lorries up to 16 t
 ≥ 140 mm for lorries exceeding 16 t
- 1.2 Bedding layer, stone chippings, poor in lime, 30-50 mm
- 1.3 Gravel base layer, poor in lime
Depth: ≥ 150 mm for cars up to 3 t
 ≥ 200 mm for lorries up to 16 t
 ≥ 250 mm for lorries exceeding 16 t
- 1.4 Filter Sheet PV
- 1.5 Retention Spacer RSX 65
- 1.6 Filter Sheet PV
- 1.7 Roof construction with root resistant waterproofing

Note:

The detailed solution shown here refers mainly to the ZinCo System Build-up. The roof construction itself as well as any other constructions are shown schematically and must be planned according to the relevant standards and guidelines.

Project:

-

Version:

18.12.2018 EVo / JGI -
Tuer01_G+F_RSX65_Fd0.dwg

Reviewed:

Scale:

none

Size:

A 4

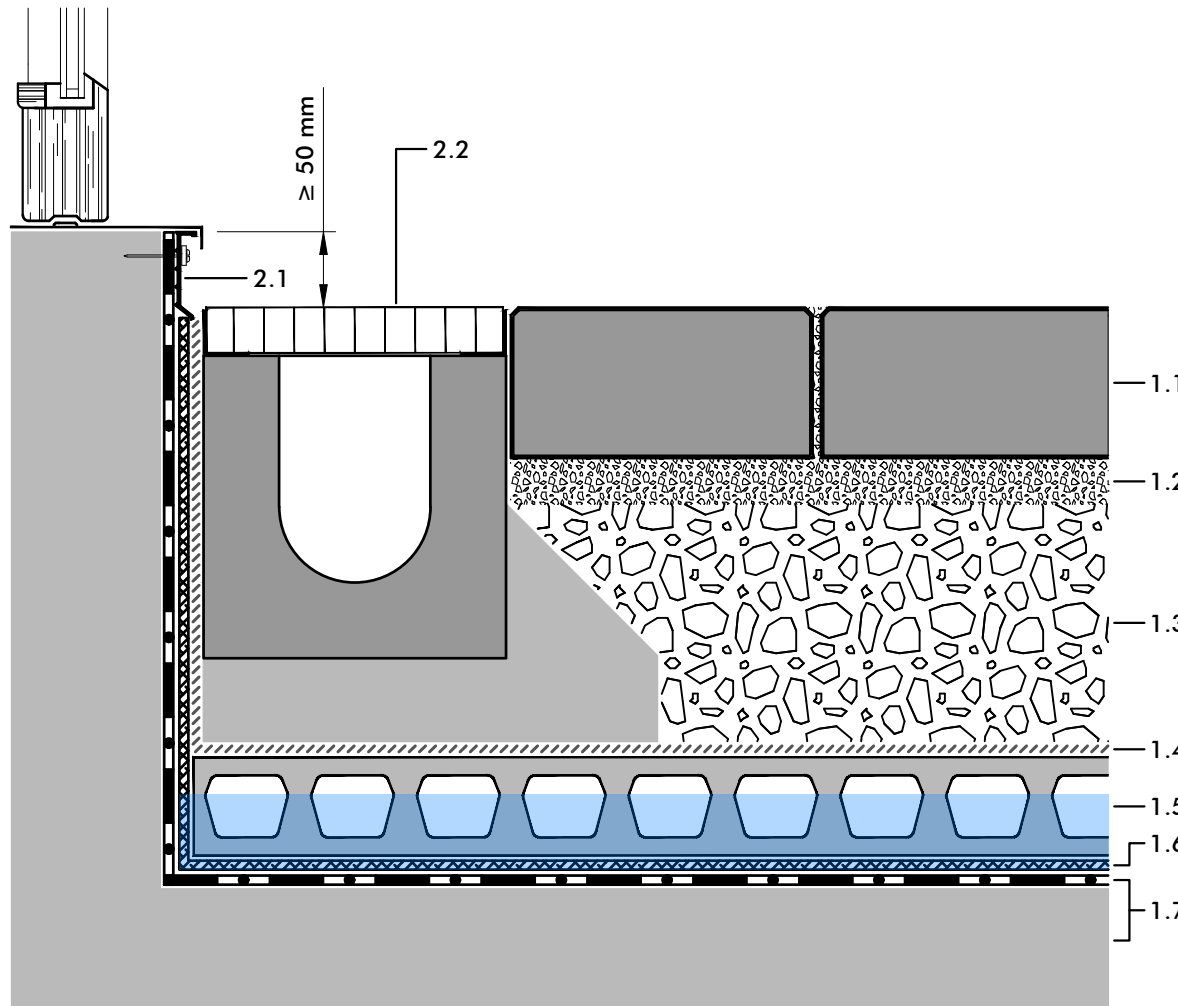

2.1 Clamping Profile AP 60

2.2 Heavy duty drainage channel in concrete foundation

Authorized by ZinCo GmbH, Lise-Meitner-Str. 2,
72622 Nuertingen/ Germany; Tel: +49/7022-6003-0
info@zinco-greenroof.com; www.zinco-greenroof.com



Subject to technical alterations and printing errors.