

# "Driveway" with Fixodrive® FX 50

**Detail:**  
Level Transition to Adjacent Terrain

**System build-up**

- 1.1 Paving, e.g. concrete pavers  
Depth: ≥ 100 mm for cars up to 3 t  
          ≥ 120 mm for lorries up to 16 t  
          ≥ 140 mm for lorries exceeding 16 t
- 1.2 Bedding layer, poor in lime, 30-50 mm
- 1.3 Gravel base layer, poor in lime  
Depth: ≥ 150 mm for cars up to 3 t  
          ≥ 200 mm for lorries up to 16 t  
          ≥ 250 mm for lorries exceeding 16 t
- 1.4 Fixodrive® FX 50 with attached filter sheet
- 1.5 Filter Sheet PV
- 1.6 Roof construction with root resistant waterproofing

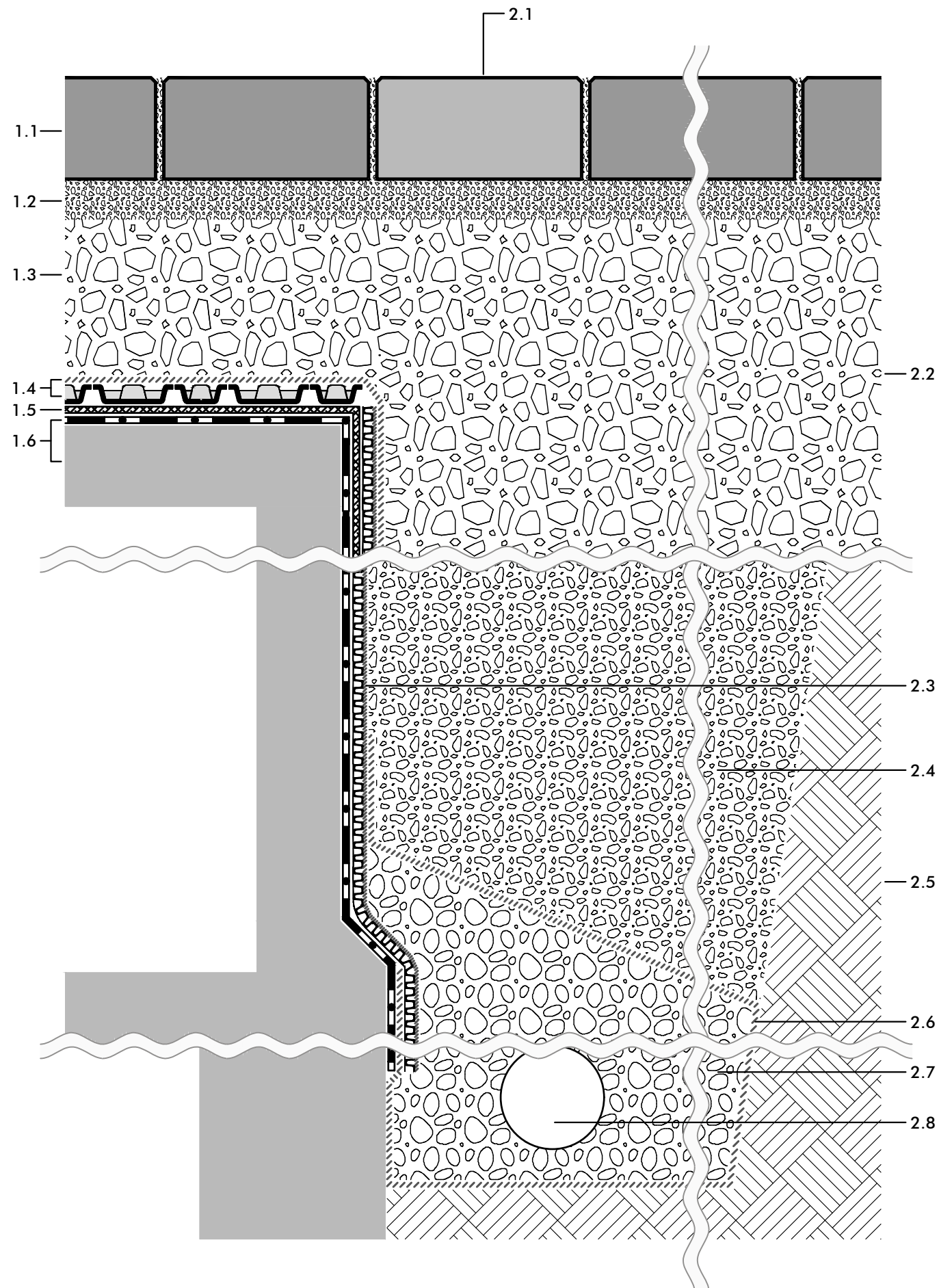

- 2.1 Separation from the filling area e.g. by coloured pavement strips (optional)
- 2.2 Gravel base layer according to on-site requirements
- 2.3 Drainage Mat DBV 10
- 2.4 Suitable backfill material professionally installed

- 2.5 Natural ground
- 2.6 Filter Sheet
- 2.7 Filter stable gravel
- 2.8 Drainage pipe

**Note:**  
The detailed solution shown here refers mainly to the ZinCo System Build-up. The roof construction itself as well as any other constructions are shown schematically and must be planned according to the relevant standards and guidelines.

**Project:**  
-

**Version:** 29.11.2018 EVo / JGI - **Reviewed:** - **Scale:** none **Size:** A 3

Dr03\_G+F\_FX50\_Fd1.dwg

Authorized by ZinCo GmbH, Lise-Meitner-Str. 2,  
72622 Nuertingen/ Germany; Tel: ++49/7022-6003-0  
info@zinco-greenroof.com; www.zinco-greenroof.com

Subject to technical alterations and printing errors.

