

"Walk- and Driveway" with Stabilodrain® SD 30

Detail:
Level Transition to Adjacent Terrain

System build-up

- 1.1 Paving, e.g. concrete pavers
Depth: ≥ 100 mm for cars up to 3 t
 ≥ 120 mm for lorries up to 16 t
 ≥ 140 mm for lorries exceeding 16 t
- 1.2 Bedding layer, stone chippings, poor in lime, 30-50 mm
- 1.3 Compacted base layer, e.g. gravel, poor in lime
Depth: ≥ 150 mm for cars up to 3 t
 ≥ 200 mm for lorries up to 16 t
 ≥ 250 mm for lorries exceeding 16 t
- 1.4 Filter Sheet PV
- 1.5 Stabilodrain® SD 30, filled with stone chippings (see 1.2)
- 1.6 Filter Sheet PV
- 1.7 Roof construction with suitable water proofing

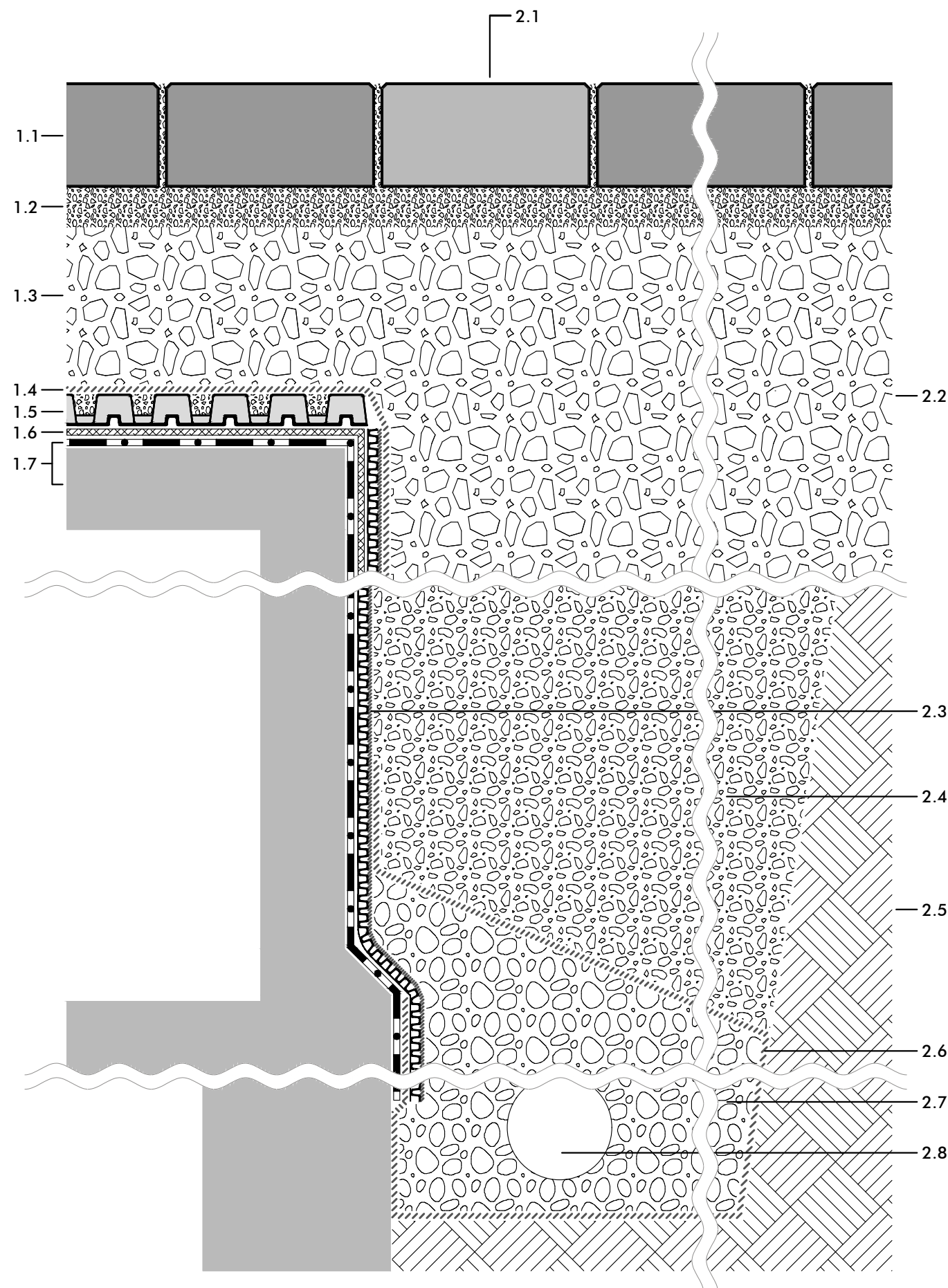

- 2.1 Separation from the filling area e.g. by coloured pavement strips (optional)
- 2.2 Gravel base layer according to on-site requirements
- 2.3 Drainage Mat DBV 10
- 2.4 Suitable backfill material professionally installed

- 2.5 Natural ground
- 2.6 Filter Sheet
- 2.7 Filter stable gravel
- 2.8 Drainage pipe

Note:
The detailed solution shown here refers mainly to the ZinCo System Build-up. The roof construction itself as well as any other constructions are shown schematically and must be planned according to the relevant standards and guidelines.

Project:

-

Version: 28.11.2018 **Reviewed:** PBi/ EVo **Scale:** none **Size:** A 3

Dr02_G+F_SD30_Fd0.dwg

Authorized by ZinCo GmbH, Lise-Meitner-Str. 2,
72622 Nuertingen/ Germany; Tel: ++49/7022-6003-0
info@zinco-greenroof.com; www.zinco-greenroof.com



Subject to technical alterations and printing errors.