

"Driveway for Lorries" with Elastodrain® EL 202

Detail:
Level Transition to Adjacent Terrain

System build-up

- 1.1 Paving, e.g. concrete pavers
Depth: ≥ 120 mm for lorries up to 16 t
 ≥ 140 mm for lorries exceeding 16 t
- 1.2 Beddign layer, poor in lime, 30-50 mm
- 1.3 Gravel base layer, poor in lime
Depth: ≥ 150 mm for lorries up to 16 t
 ≥ 150 mm for lorries exceeding 16 t
- 1.4 Filter Sheet PV
- 1.5 Elastodrain® EL 202
- 1.6 Slip Sheet TGF 20 (2 layers)
- 1.7 Roof construction with root resistant waterproofing

Note:
The detailed solution shown here refers mainly to the ZinCo System Build-up. The roof construction itself as well as any other constructions are shown schematically and must be planned according to the relevant standards and guidelines.

Project:
-

Version:	Reviewed:	Scale:	Size:
23.11.2018 EVo/ JGI	-	none	A 3

Dr03_G+F_LKW_EL202_Fd1.dwg

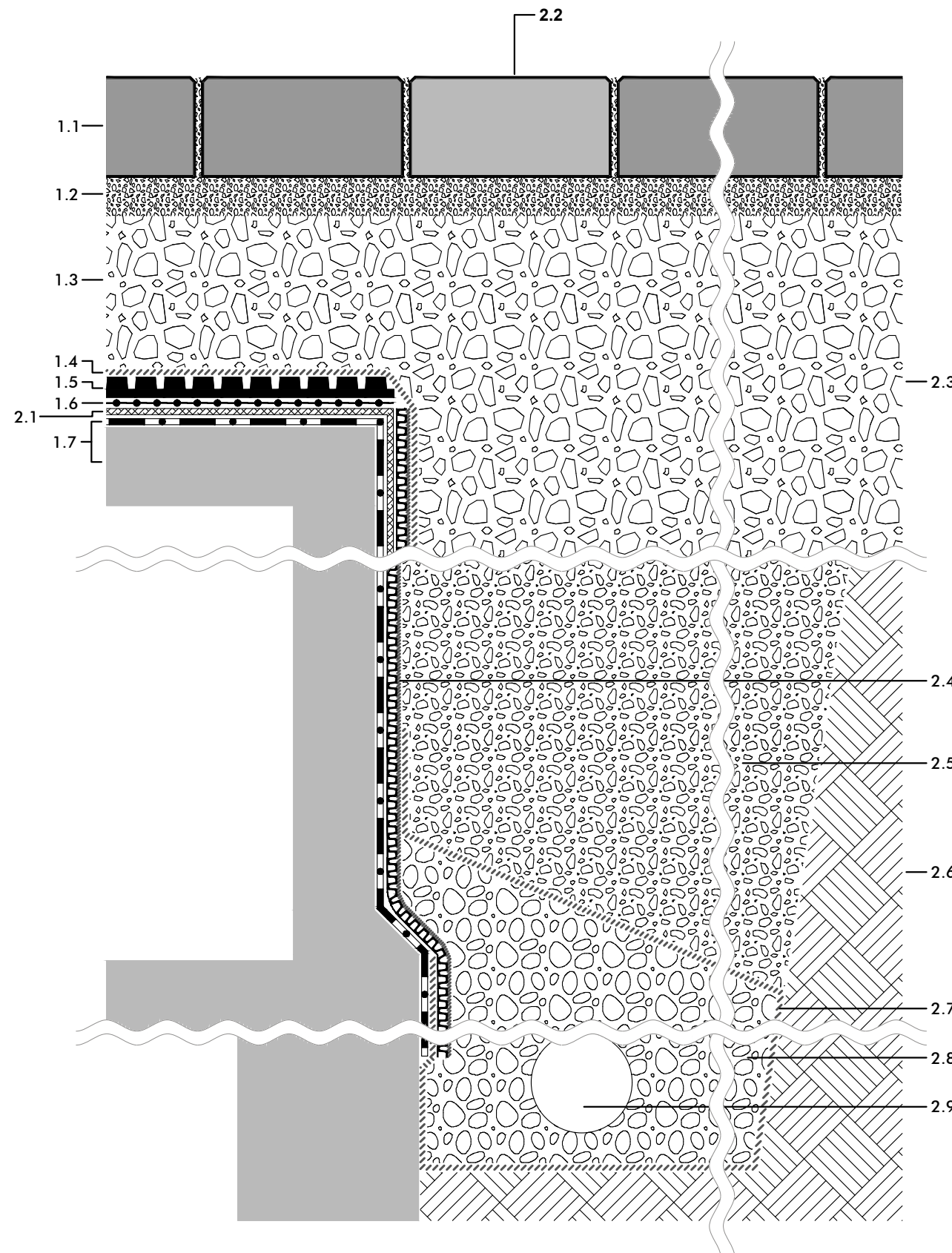

- 2.1 Protection Mat Strip SM-R to cover the transition from horizontal to vertical building structure
- 2.2 Separation from the filling area e.g. by coloured pavement strips (optional)
- 2.3 Gravel base layer according to on-site requirements
- 2.4 Drainage Mat DBV 10

- 2.5 Suitable backfill material professionally installed
- 2.6 Natural ground
- 2.7 Filter Sheet
- 2.8 Filter stable gravel
- 2.9 Drainage pipe

Authorized by ZinCo GmbH, Lise-Meitner-Str. 2,
72622 Nuertingen/ Germany; Tel: ++49/7022-6003-0
info@zinco-greenroof.com; www.zinco-greenroof.com



Subject to technical alterations and printing errors.