

# "Driveway for Cars" with Elastodrain® EL 202

## Detail:

Edging between Hard Landscape and Vegetation

### System build-up

- 1.1 Paving slab  
Depth: ≥ 100 mm for cars up to 3 t
- 1.2 Bedding layer, poor in lime, 30-50 mm
- 1.3 Filter Sheet PV
- 1.4 Elastodrain® EL 202
- 1.5 Slip Sheet TGF 20 (2 layers)
- 1.6 Roof construction with root resistant waterproofing

### Note:

The detailed solution shown here refers mainly to the ZinCo System Build-up. The roof construction itself as well as any other constructions are shown schematically and must be planned according to the relevant standards and guidelines.

### Project:

-

**Version:**                      **Reviewed:**                      **Scale:**                      **Size:**

04.02.2019 JGI/JGI -                      none                      A 4

Abgr01\_G-F\_Pkw\_EL202\_Fd1.dwg

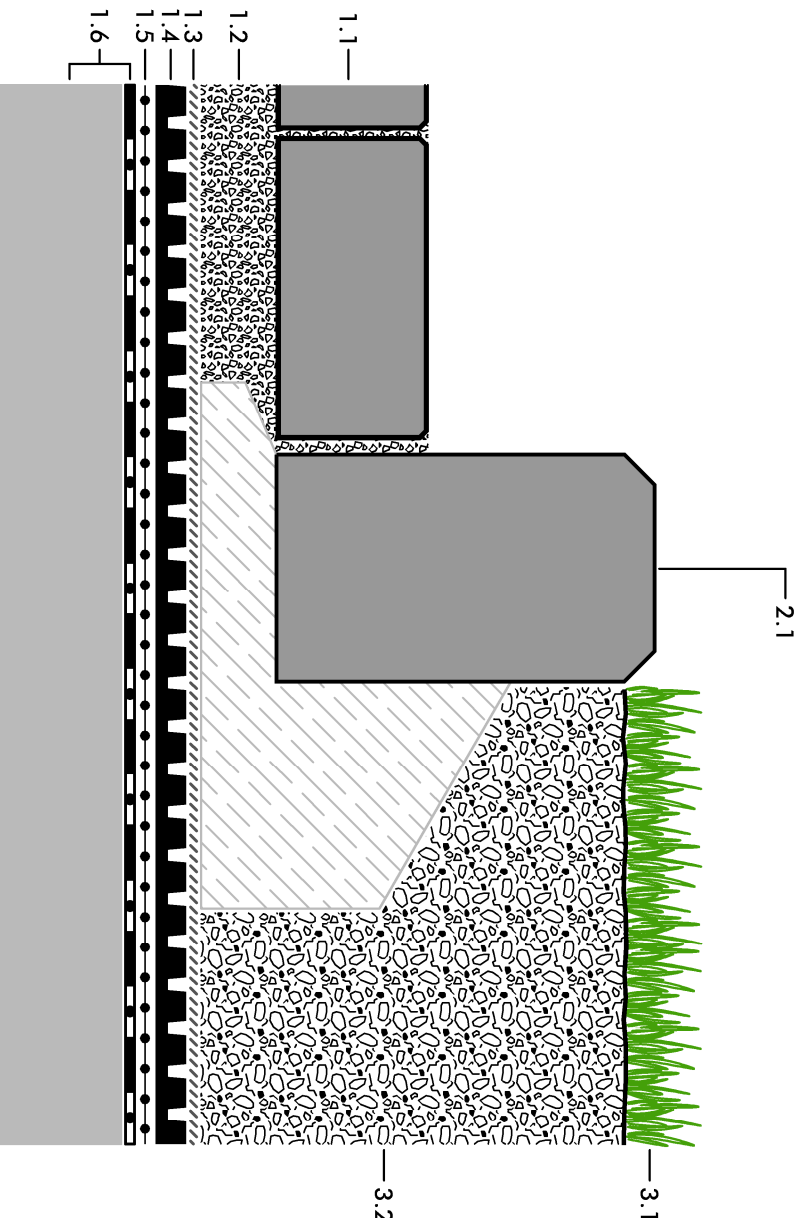

2.1 Concrete kerb in concrete foundation

3.1 Lawn, perennials, with sufficient substrate depth also shrubs and small trees

3.2 System Substrate "Roof Garden" or System Substrate "Lawn", from 200 mm for a total substrate depth of more than 350 mm with Zincolit® Plus as mineral sub-substrate

Authorized by ZinCo GmbH, Use-Meiner-Str. 2,  
72622 Nuerringen/ Germany, Tel: +49/7022-6003-0  
Info@zinco-greenroof.com; www.zinco-greenroof.com



Subject to technical alterations and printing errors.